

## SUBMITTING PHOTOS

### CANDID PHOTOS (12-15 IMAGES)



## HISTORICAL TIMELINE (3-5 IMAGES)



## PASTOR SIGNATURE, HEADSHOT AND CHURCH LOGO

*Thomas R. Webb*



Vector format preferred

## ARCHITECT RENDERINGS, FLOORPLANS, ELEVATIONS, ETC.

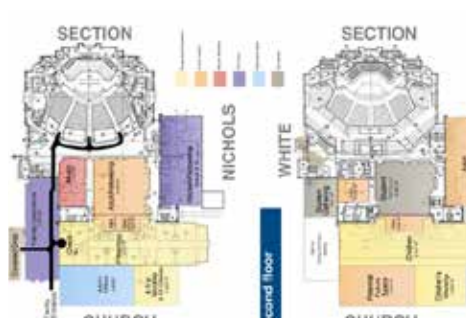
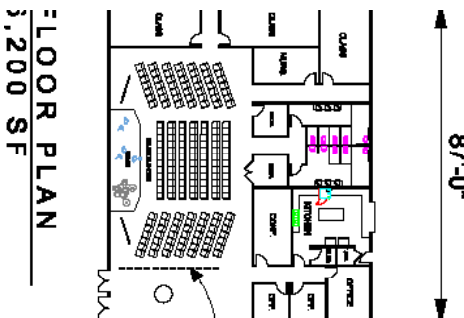

If you are conducting a debt campaign, please submit more candid photos and photos that represent ministries that could be impacted if there was no debt.

## **REQUIREMENTS**

Some of the promotional items will require you to submit photographs or other artwork (such as blueprints, an artist's rendering of the proposed facilities, photos of the congregation). Recruit someone in the congregation who can take high-quality digital photos as needed.

In order to use original photos or documents for printed materials, items must be submitted per the following electronic file guidelines. When photos (particularly old ones) are scanned, please adhere to these requirements:

- Minimum resolution: 300 dpi
- Minimum size: 100 percent of the original photo size
- File format: TIFF, JPEG, or EPS